

A Culture of Health: Awareness and Action

Traci Rose Rider, PhD, LEED AP, WELL AP | North Carolina State University, Assistant Professor

Dina Miris Sorensen, Associate AIA, LEED AP | d.studio, Founder and Design Director

Kelsey Jordan, Associate AIA, WELL AP, Fitwel | Legat Architects, Educational Planner and Designer

Robin Randall, FAIA, ALEP, LEED BD + C | Legat Architects, Principal and Director of Education

Agenda:

- **Welcome**
- **Gathering**
- **Equity and Belonging**
- **Small Breakout**
- **Human Resilience**
- **Small Breakout**
- **What's Next?**



EQUITY and BELONGING

**“It’s hard to have an open mind if you don’t
have an open heart.”**

-Adam Grant



Synergy Planning – Belonging

Crow Island School, Winnetka IL. Photo Courtesy: James Steinkamp, photographer



Synergy Planning – Equity

Playful Learning Landscapes™ Kathy Hirsh-Pasek <https://kathyhirshpasek.com>







SYNERGIES

The interaction or cooperation of two or more organizations, substances, or other agents to produce a combined effect greater than the sum of their separate effects.

286+
Million
Vehicles



Photo Courtesy: Dr. James Sallis _ Active Living Research

20+
Million
Children
Ages 5-14
Commute



Active Navigation



Can physical activity help children learn? Brain scans during a cognitive test

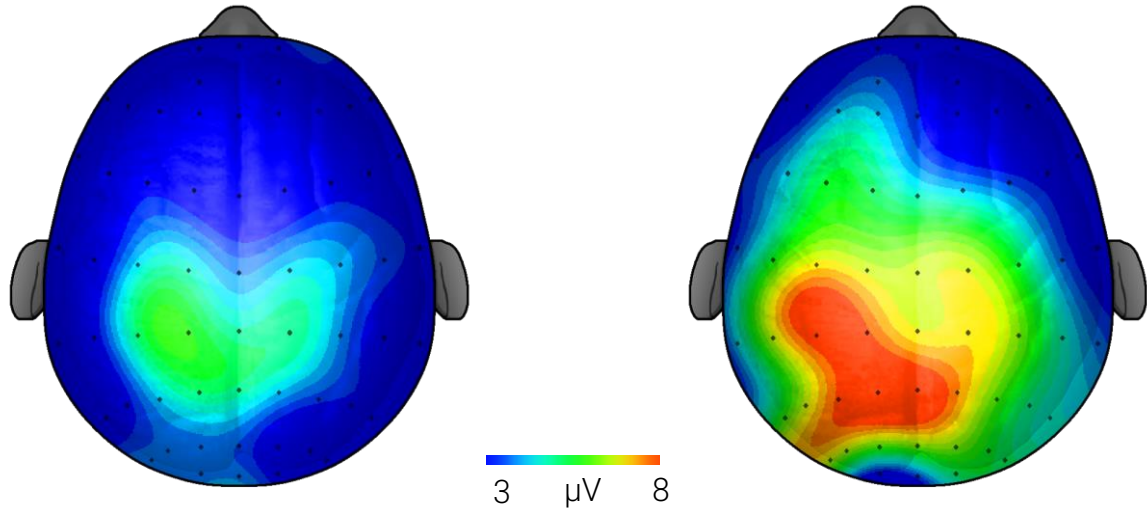

After 20 minutes of
Sitting Quietly

After a 20 minutes of
Walking

Design for Active Navigation



Photo Courtesy: Dr. James Sallis _ Active Living Research



Topic 1: Equity and Belonging



Image courtesy of RATIO Architects



Image courtesy of RATIO Architects

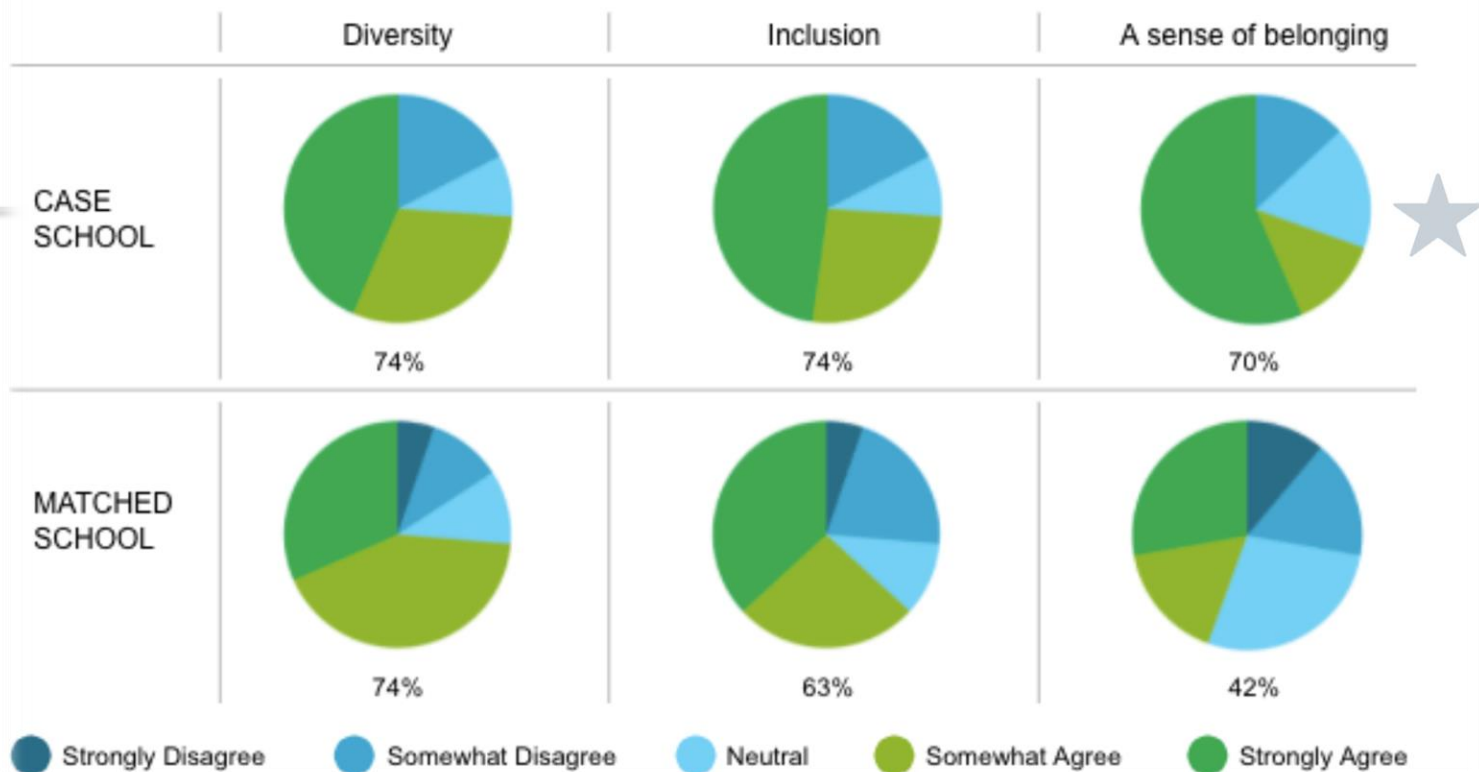

Image courtesy of RATIO Architects

Data Collection

- Online, anonymous survey (Sp-Su 2021)
- Mix of open and close-ended questions developed with SDOH as guiding categories
- Each SDOH “module” had 3-5 Likert scale questions aiming to operationalize health equity in school environments
- “Neighborhood and built environment” module contained 10-15 close-ended questions about participant experiences and indoor/ outdoor environments

I believe my school actively promotes...



My school actively engages the community

I feel connected to the community

I believe the community feels connected to my school

CASE SCHOOL

CASE SCHOOL

CASE SCHOOL



62%

62%

62%

MATCHED SCHOOL

MATCHED SCHOOL

MATCHED SCHOOL



32%

32%

21%



Strongly Disagree



Somewhat Disagree



Neutral



Somewhat Agree



Strongly Agree

Question for the Audience

Do you design with Equity and Belonging?

What are your best practices?

What are your challenges?

RESILIENCE

“The places where we live and learn are the grounds on which we stand and the springboards from where we leap.”

-Edith Ackermann



98+
Thousand
U.S. Public
Schools

Schoolyards - Sites Out of Mind

Eagle Rock Jr/Sr High School, Los Angeles CA. Photo Courtesy: Claire Latane



Schoolyards as Learning Landscapes

Manassas Park ES, Manassas Park VA. Photo Courtesy: VMDO Architects & OWSW



Schoolyards as Learning Landscapes

Manassas Park ES, Manassas Park VA. Photo Courtesy: VMDO Architects & OWSW







SENIOR CENTER



Group Name
SIGN UP SHEET

This area allows you to enter some descriptive text about your sign up. Use it to give your members instructions or to clarify on the details of the event. Enter as little or as much text as you need to get your message across. This area allows you to enter some descriptive text about your sign up. Use it to give your members instructions or to clarify on the details of the event. Enter as little or as much text as you need to get your message across.

CREATED BY: Dawn Mulholland [CONTACT ME](#)

Location	Item to Bring
Location 1	Drinks (2) Snacks
Location 2	Drinks (2) Snacks
Location 1	Drinks (2) Snacks
Location 3	Drinks (2) Snacks
Location 1	Drinks (2) Snacks





Topic 2: Human Resilience

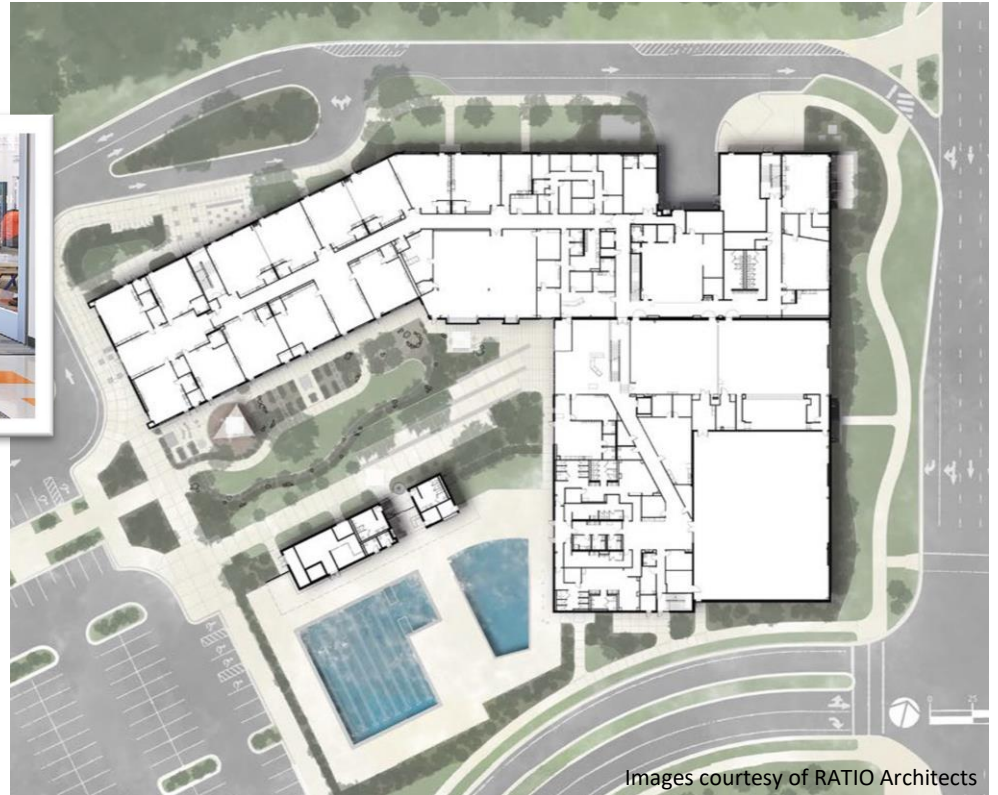

Image courtesy of RATIO Architects



Image courtesy of RATIO Architects

Topic 2: Human Resilience



Images courtesy of RATIO Architects

My school actively prioritizes the students'...

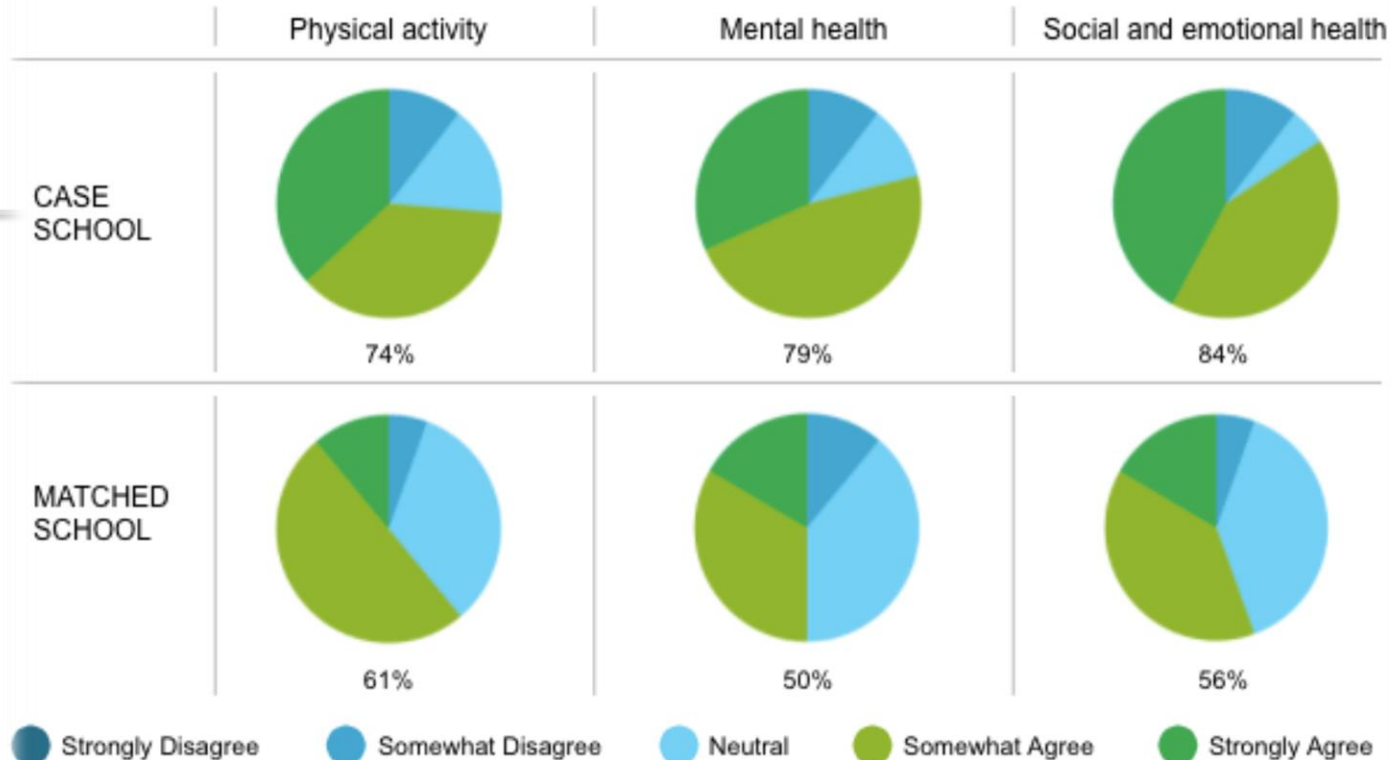

When I am inside my school, I feel I have access to...

Natural elements



79%

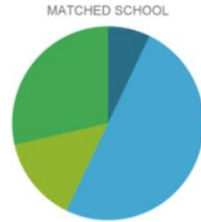

43%

Spaces that promote physical activity

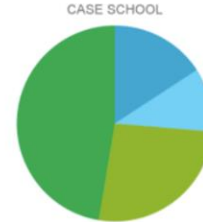

74%

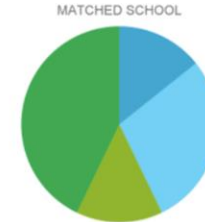

57%

Natural daylight

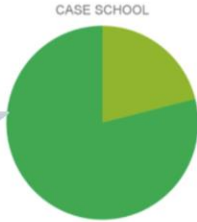

100%

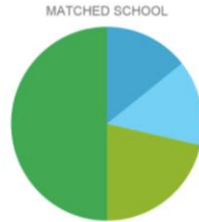

71%

Spaces that promote mental health and wellness

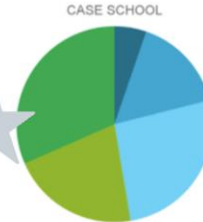

53%

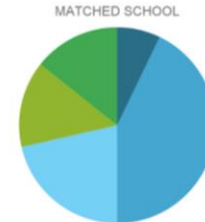

29%

Strongly Disagree Somewhat Disagree Neutral Somewhat Agree Strongly Agree

Question for the Audience

**Do you design for Resilience?
What are your best practices?
What are your challenges?**

MEANINGFUL CHANGE

“I always wanted to make a difference, but it was always along the lines of...when I grow up. It’s sad that it has to be this way, but I realize I don’t have time to grow up before I want to make a change.”

-Ta’Kaiya Blaney

Tla’amin First Nation | British Columbia



Photo Courtesy: Abe Moore, *Take it Outside*

What's next?



Images courtesy of RATIO Architects

NC STATE College of Design

Question for the Audience

Do you design for meaningful change?

What are your best practices?

What are your challenges?