



San Antonio, TX

October 5-9, 2022

MARRIOTT RIVERCENTER

learningSCAPES 2022
A CALL TO ACTION

*“Fostering Higher Levels of Engagement,
Equity, and SEL through Personalized
Active Learning Environments”*



October 8, 2022
11:00am - 12:00pm
Salon D



Brian Proctor
Principal
Walnut Grove
Elementary School

Mark Beebe, AIA
Partner
LANCER+BEEBE
Architects

Mr. Mark Beebe

AIA, Partner, BEEBE Design | RATIO

Mr. Brian Proctor

Principal, Walnut Grove Elementary, CGCSC

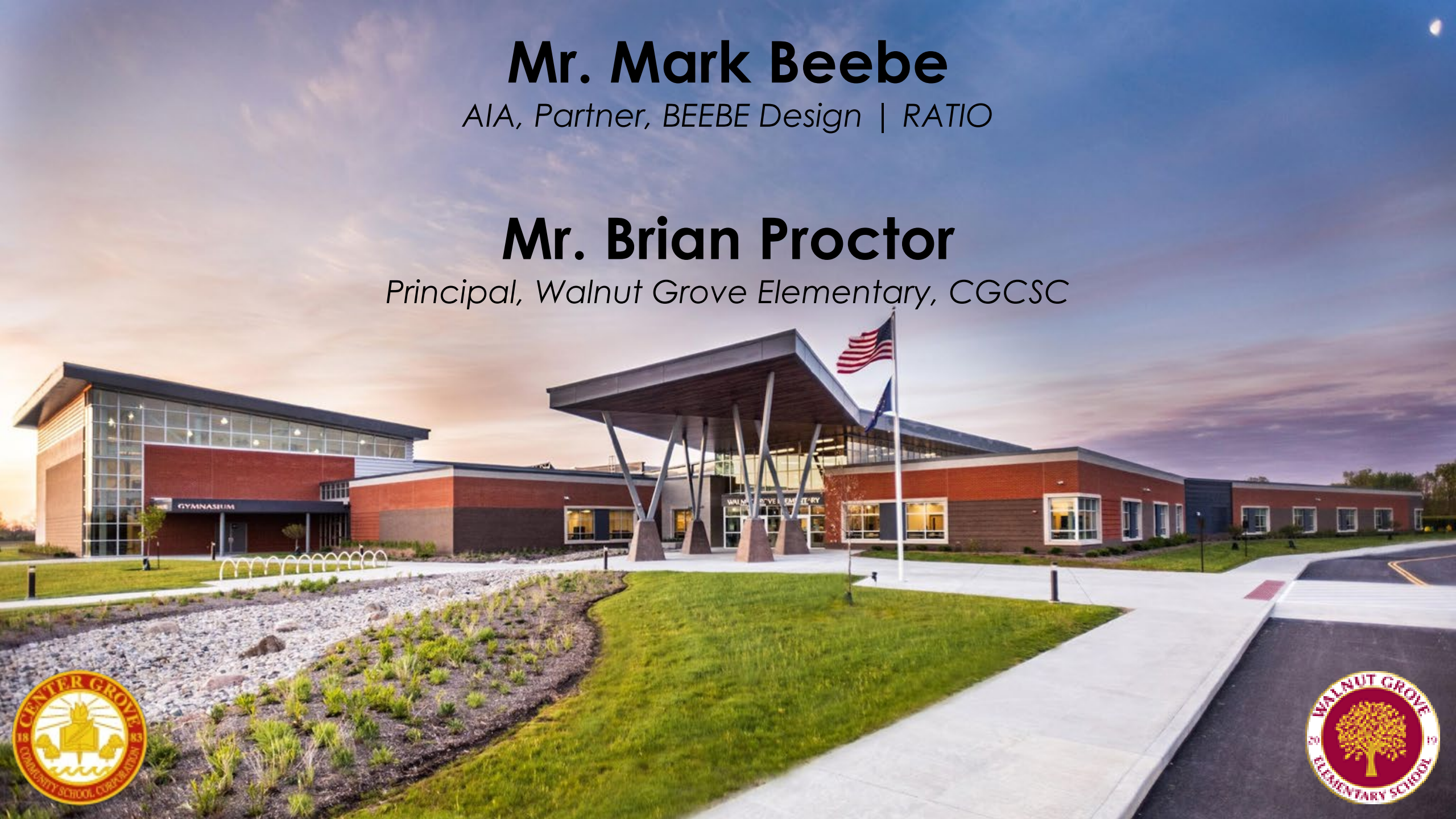

Audience Engagement

Go to
www.menti.com

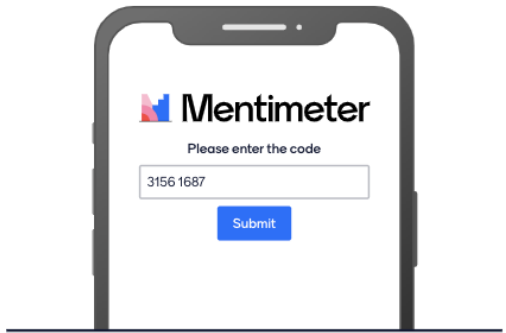

Enter the code
1616 7710



<https://www.mentimeter.com/app/presentation/alex2ab2m9ktd7xg6mvwk3kphfworzgu>



Learning Objectives

What it means to 'Personalize' an Active Learning Environment and how instruction promotes appropriate SEL well-being and positive behavioral traits.

How 'PAL' Environments create equity and engagement across all learners, as well as better equip staff, with this goal.

How can 'PAL' Environments positively impact school culture, and how does this factor into student success and well-being?

Overcoming a fixed mindset in implementing student-centric instruction and innovative learning environments within any school district.



WHY? WHAT? HOW?

(WHY) How SEL impacts all learner's ability to engage and succeed. Primary learning objectives:

- More than just a buzzword, real data showing effects of SEL on student success
- Identifying SEL inhibitors
- Creating safe spaces for youth to experience emotions, express them, and learn about handling their own emotions and the emotions of others.

(WHAT) Mindset, paradigm shift or 'pivot', personalized active learning spaces to engage the wide spectrum of where students are.

- Learner choice and education 'ownership'
- Promoting student self-regulation
- Student-centric, 'explorative' delivery

(HOW) Learning spaces to support paradigm shift.

- Promoting flexibility / agility / movement
- Connections to nature and 'biophilic' learning elements
- Identifying with larger student 'communities'



Conditions for Learning

**Conditions
for learning**

PBIS

**Character
Education**

**Trauma
Responsive**

Circles

SEL

**Classroom
management**



Social-Emotional Learning

The ability to have **body awareness** and recognize sensations in the body.

Gaining sensory-motor integration is an important skill for **managing transitions**, changing routines, **increasing alertness for learning**, and improving regulation.

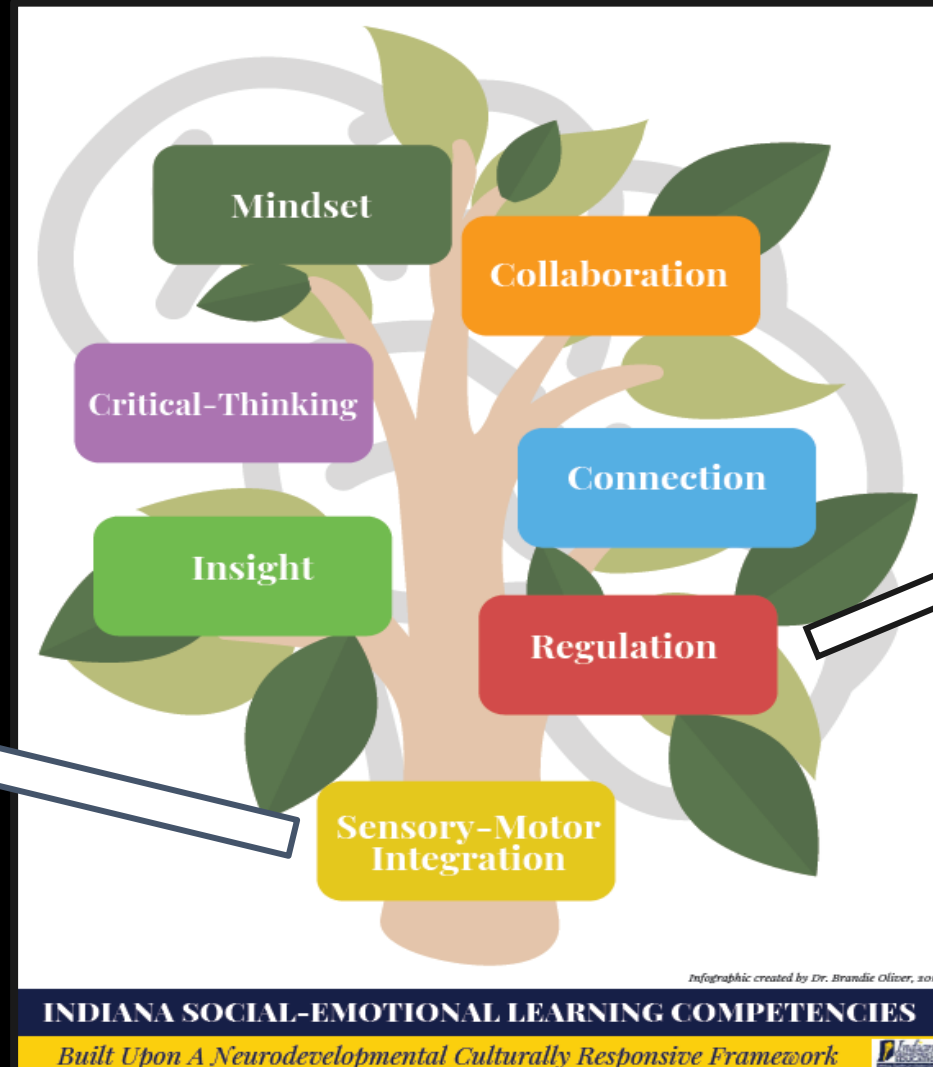

The ability to **recognize** and **manage** one's emotions.

Regulation skills build positive self control, positive self-discipline, and impulse control.



Whole Child Learning

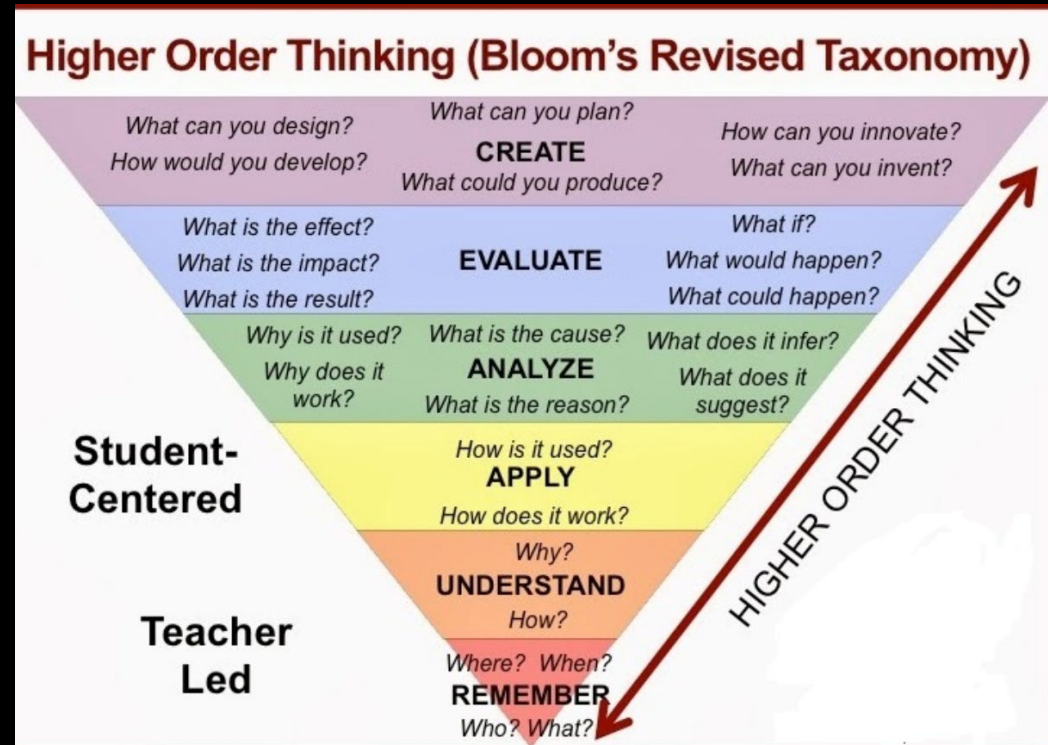
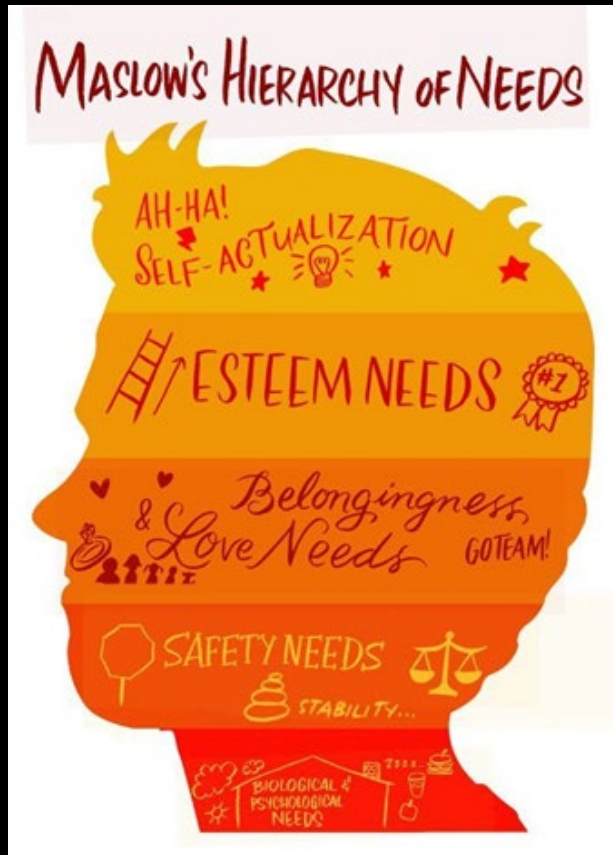

Benefits for Staff and Learners

1. Natural light / white-tunable lighting
2. Minimize distractions
 - a. works to decrease stimulation
3. Spaces that foster collaboration
4. Color coding / Creating Community
 - a. awareness of location in building (wayfinding)
5. Intentional infusion of nature
 - a. grass, carpet, and visuals



LOVE what you DO!

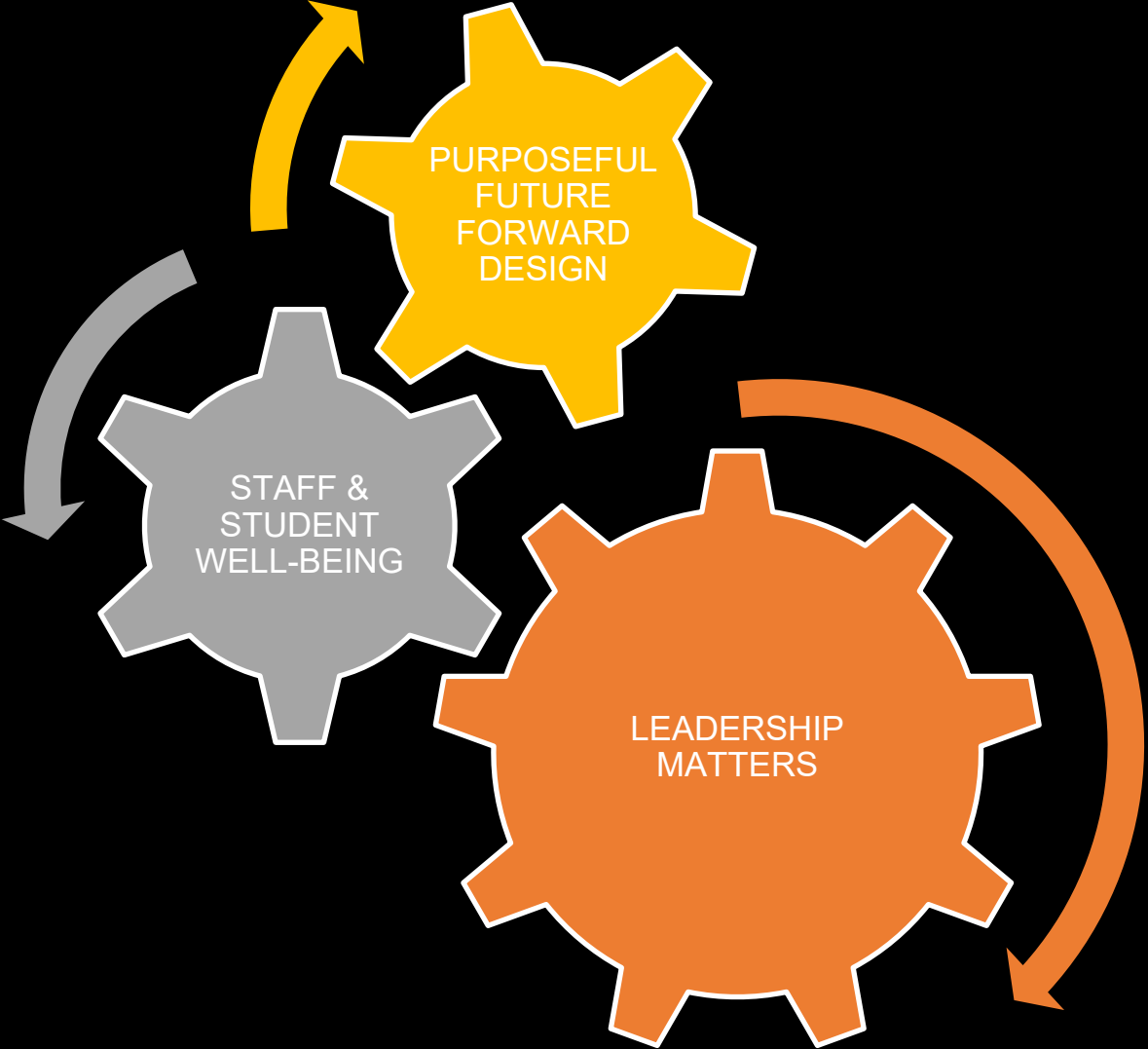

I. WGE Overview/History/Summary

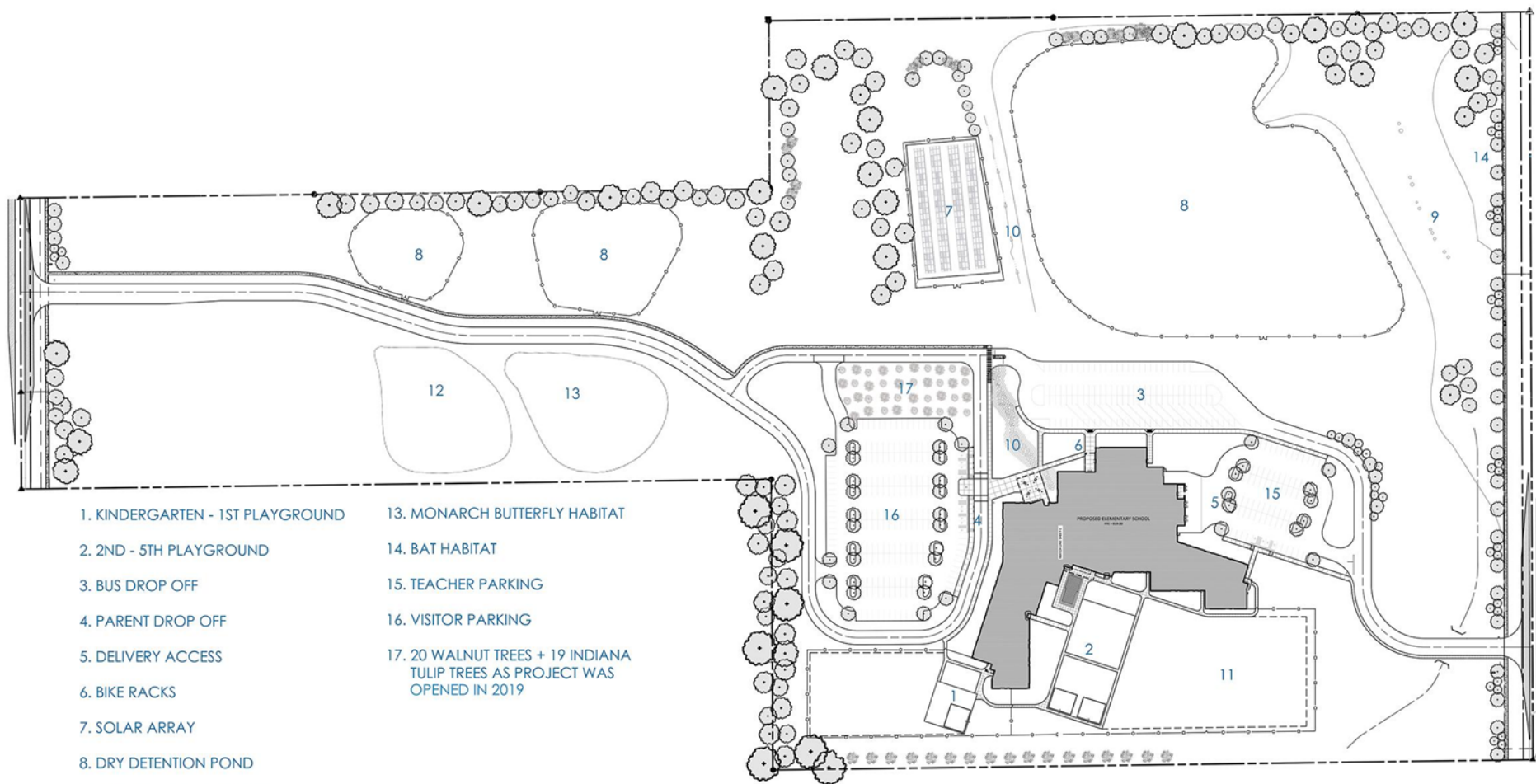

- | | |
|----------------------------------|--|
| 1. KINDERGARTEN - 1ST PLAYGROUND | 13. MONARCH BUTTERFLY HABITAT |
| 2. 2ND - 5TH PLAYGROUND | 14. BAT HABITAT |
| 3. BUS DROP OFF | 15. TEACHER PARKING |
| 4. PARENT DROP OFF | 16. VISITOR PARKING |
| 5. DELIVERY ACCESS | 17. 20 WALNUT TREES + 19 INDIANA TULIP TREES AS PROJECT WAS OPENED IN 2019 |
| 6. BIKE RACKS | |
| 7. SOLAR ARRAY | |
| 8. DRY DETENTION POND | |
| 9. WETLAND / FROG POND | |
| 10. DRAINAGE SWALE | |
| 11. GEOTHERMAL FIELD | |
| 12. BEE POLINATOR PROJECT | |

🕒 OVERALL SITE PLAN
0' 100' 200'



I. WGE Overview/History/Summary

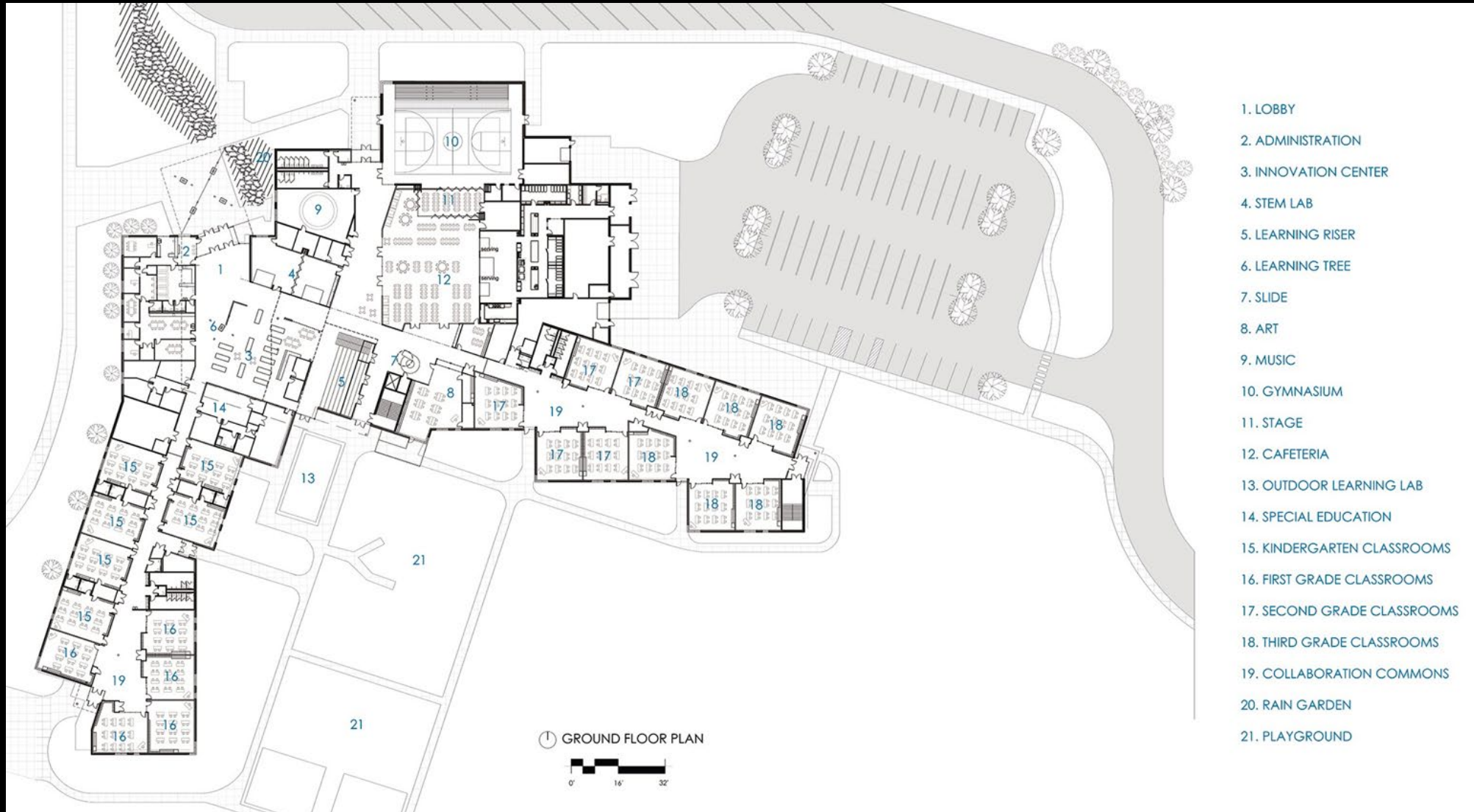

I. WGE Overview/History/Summary

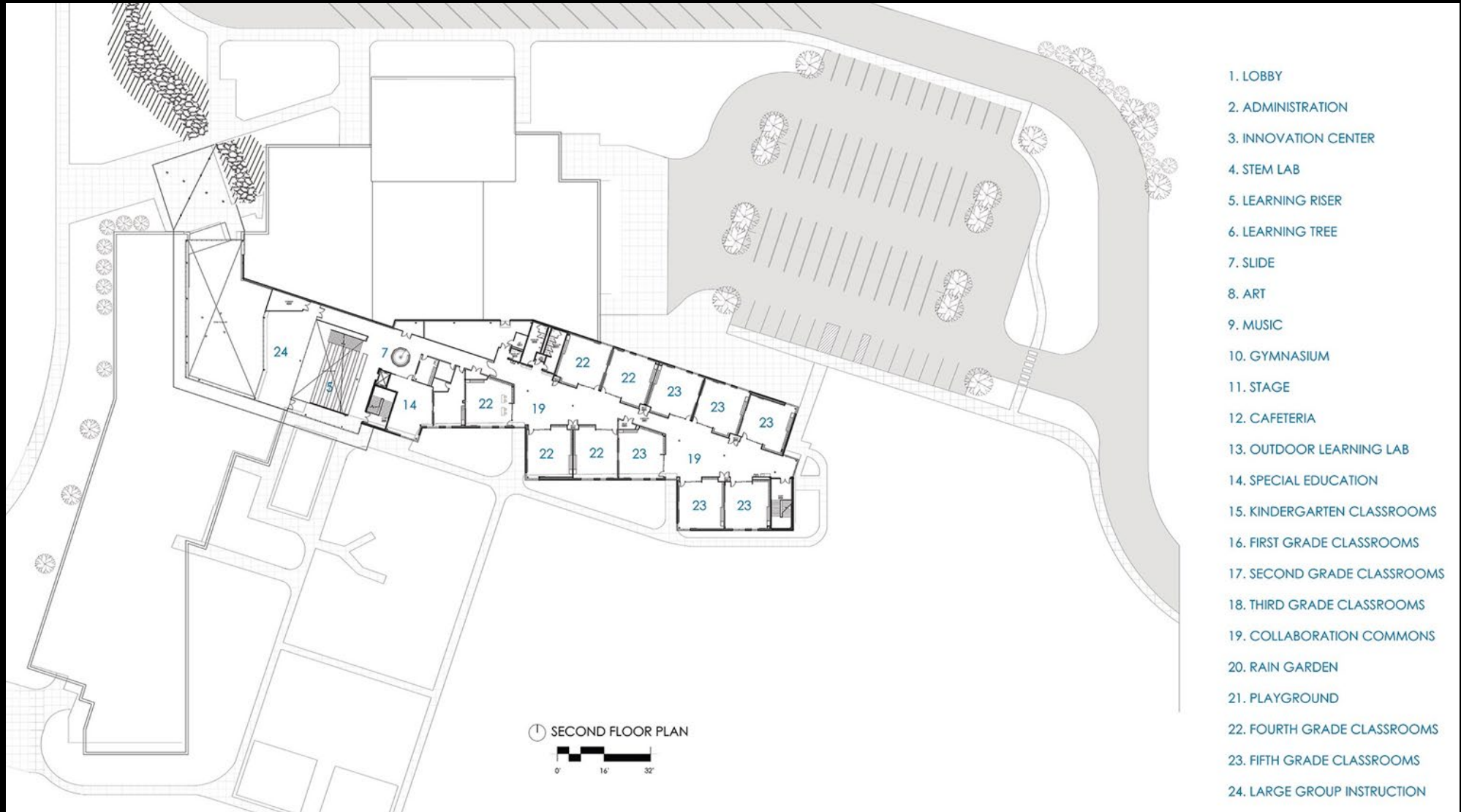

Leadership MATTERS!



What is your leadership lens?

The right culture connects emotions with design. Without it, we have a system of compliance and routines without a vision.



What impact are you leaving for your scholars?



Impact...

In a world that is constantly changing, are you impacting it in a way that changes ideas, provokes creativity, and inspires positive thinking?



Your MINDSET changes the outcome!



How does your environment impact student learning, emotional growth, and personal experiences?



HAPPINESS is an AMAZING feeling!



How can this positively affect student social/emotional well-being?



LOVE HOW YOU LEARN!

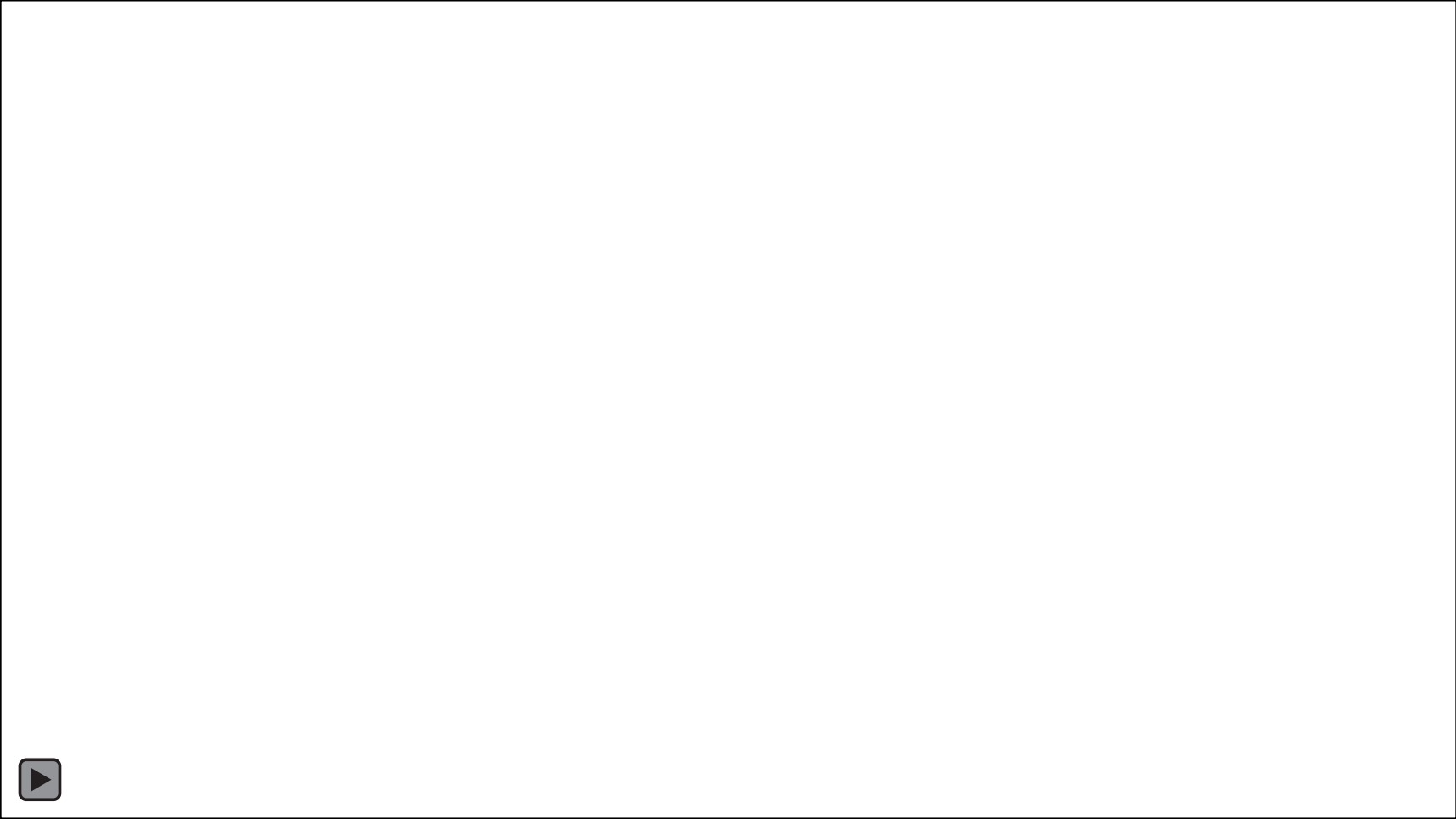

Change the **OUTCOME!**



Lori Desautels, published author focused on Applied Education Neuroscience, shares that, “Children who develop inside environments with never-ending fear are not able to regulate their nervous systems and we punish that fear because we only look at behaviors! Schools can be the safe spaces where we model neural exercise for regulation.”



Interconnectedness of 'Innovative' Learning Environments



All of it has a purpose.

It's not about being fearful or a pioneer. It's about being proactive and connecting innovative learning environments to the needs of our quickly changing learners.



Have a VISION That Challenges Your Design Lens



Invest in the learner that hasn't started school yet.

Your vision is focused on students, not whether the teacher desk and filing cabinets are large enough.

Change is a good thing in education!



FOCUS: Will your environments support kids in 5, 10, or 20 years?



Past practice shouldn't define future needs.

Value learner changes today.

Pivot your thinking for growth tomorrow.



RESPONSIBILITY to be RESPONSIVE With DESIGN



Prioritize what we do for our staff and students. The environment must connect with all scholars and educators in a responsive and responsible manner.



Think CREATIVE! Dream Big! Have Fun!



A positive culture understands space, realizes potential of all, and is connected with culture and climate. Leaders need to dream bigger than what they ever experienced as a learner!



Be Different, Think Different!



V. Applying 'PAL' Environment principles to existing schools

Walnut Grove
Elementary K-2



V. Applying 'PAL' Environment principles to existing schools

Walnut Grove
Elementary K-2



V. Applying 'PAL' Environment principles to existing schools

Walnut Grove
Elementary 3-5



V. Applying 'PAL' Environment principles to existing schools

Walnut Grove
Elementary 3-5



Q/A



Thank you!!