



Rebuilding a School and Rebuilding a Community

The Path to Reinventing Fremont High School



Meet your Speakers



Nidya Báez
Principal
Fremont High School
Oakland Unified
School District



Aaron Jobson, AIA, ALEP
President
Quattrocchi Kwok
Architects



Joel Williams
Studio Lead
Quattrocchi Kwok
Architects



Agenda

- **Oakland and Fremont High School Context and History**
- **Project Overview**
- **Lessons Learned**
- **Results and Impact**
- **Discussion**



Community Ownership



History and Context

City of Oakland and Fremont High School





East Oakland



Fremont High School





Challenges

- Issues of neglect and dysfunction
- Organizational dynamics added layers of complexity
- Charter schools in Oakland
- Academics/Small schools
- Enrollment decline
- Instability in leadership and vision for the school

Lost Community Ownership and Connection

Project Overview

- Scope:
 - New 12 classroom building
 - New gym, wellness center and stadium
 - Modernized CTE building
 - New Admin entry and re-clad library
- Budget:
 - \$131M Total Project Cost
 - \$97M Construction Cost



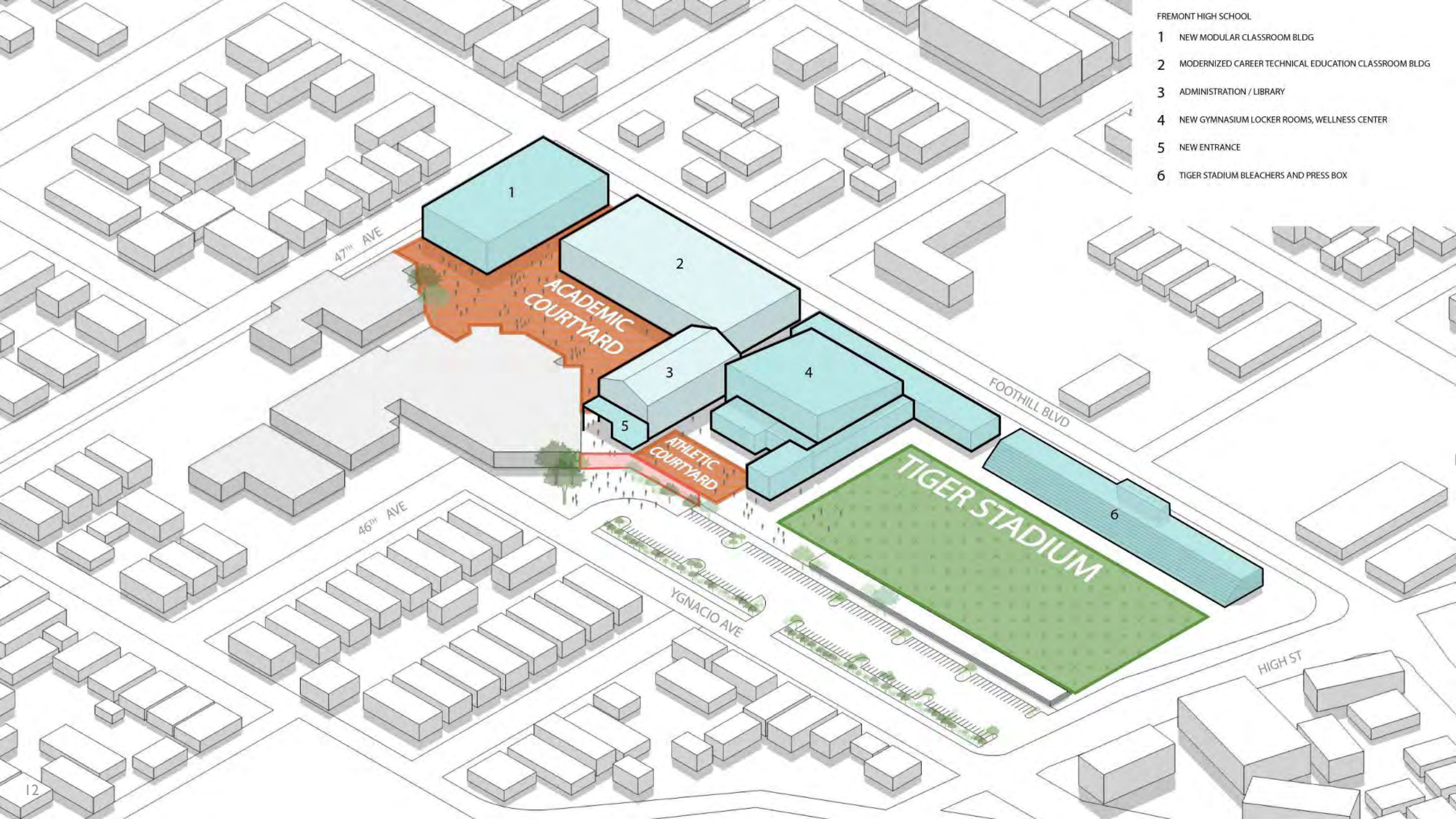

- FREMONT HIGH SCHOOL
- 1 NEW MODULAR CLASSROOM BLDG
 - 2 MODERNIZED CAREER TECHNICAL EDUCATION CLASSROOM BLDG
 - 3 ADMINISTRATION / LIBRARY
 - 4 NEW GYMNASIUM LOCKER ROOMS, WELLNESS CENTER
 - 5 NEW ENTRANCE
 - 6 TIGER STADIUM BLEACHERS AND PRESS BOX

47TH AVE

46TH AVE

YGNACIO AVE

FOOTHILL BLVD

HIGH ST

ACADEMIC
COURTYARD

ATHLETIC
COURTYARD

TIGER STADIUM



Sustainability

- ZNE Master Plan
- CHPS Verified Project
- High Indoor Environmental Quality
- Energy and water efficient
- Daylighting and exterior shading



Project Timeline

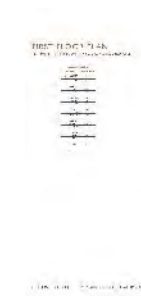
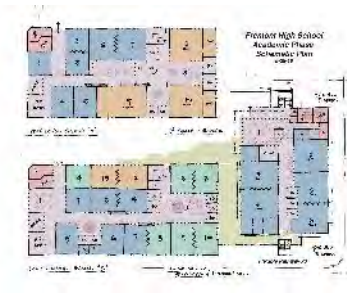
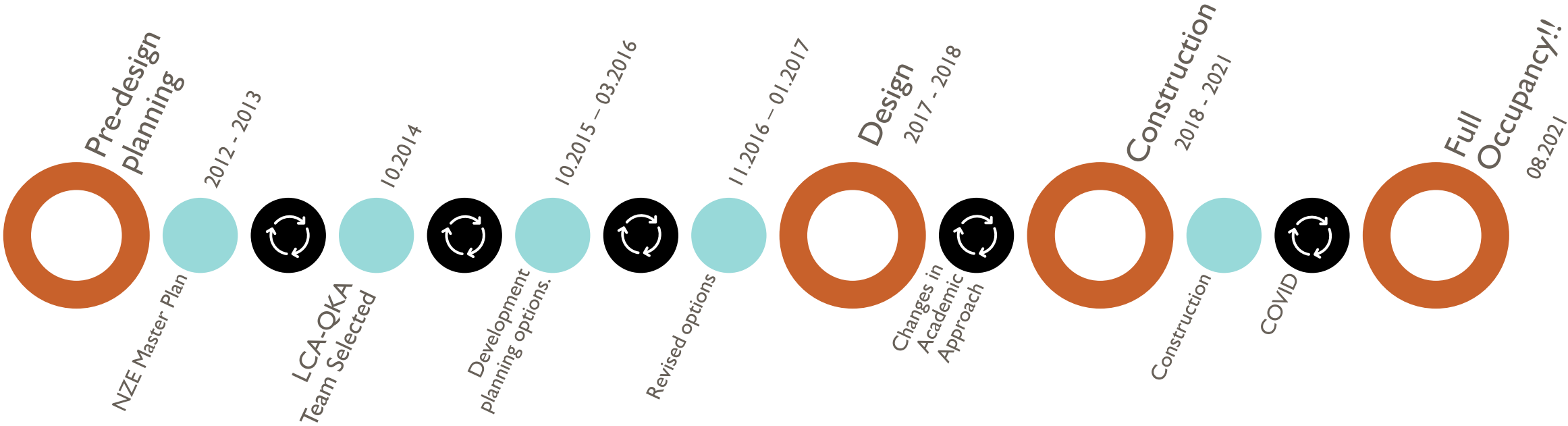



Lessons Learned



Form a Discussion Group of 4

- Introduce yourselves
- 2:00



02:00

mins: secs: type:
 ▾

Breaktime for PowerPoint by Flow Simulation Ltd. Pin controls when stopped

HOW CAN A FACILITIES PROJECT RE-BUILD COMMUNITY OWNERSHIP?





SCIENCE, HEALTH & FORENSICS



DIGITAL MEDIA & TECHNOLOGY



PUBLIC SERVICE & GLOBAL STUDIES



ENGINEERING & ARCHITECTURE

LINKED LEARNING PATHWAYS



PROJECT BASED *and* BLENDED LEARNING DESIGN THINKING PEER TEACHING

RESTORATIVE PRACTICES
STRUCTURED EXTENDED DAY
SHARED GOVERNANCE
HEALTH CLINIC

CREATING a NEIGHBORHOOD QUALITY SCHOOL for our CHILDREN

6-12 MIDDLE AND HIGH SCHOOL
4 PATHWAYS + NEWCOMER + SPED PROGRAMS

NEW ZERO NET ENERGY FACILITY COMPLETED

1. Community Engagement is Foundational

INTENSIVE SUPPORT SCHOOLS INITIATIVE 2015

2021

Consistent and Organized

- Planning through Construction
- External communications to keep community informed
- Driven by District policy and community expectations
- Partnership between District, School and Design Team

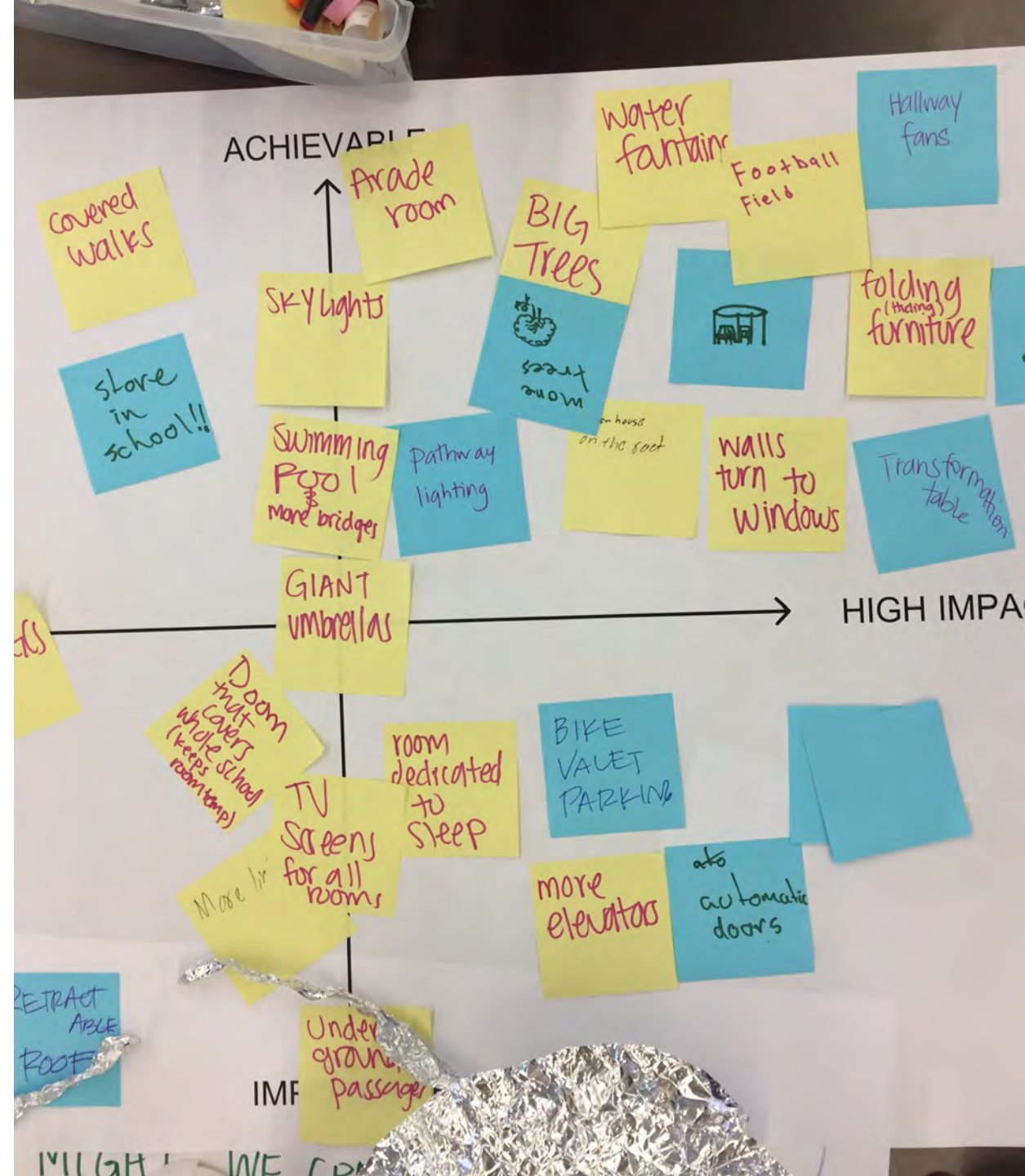

COMMUNITY MEETINGS

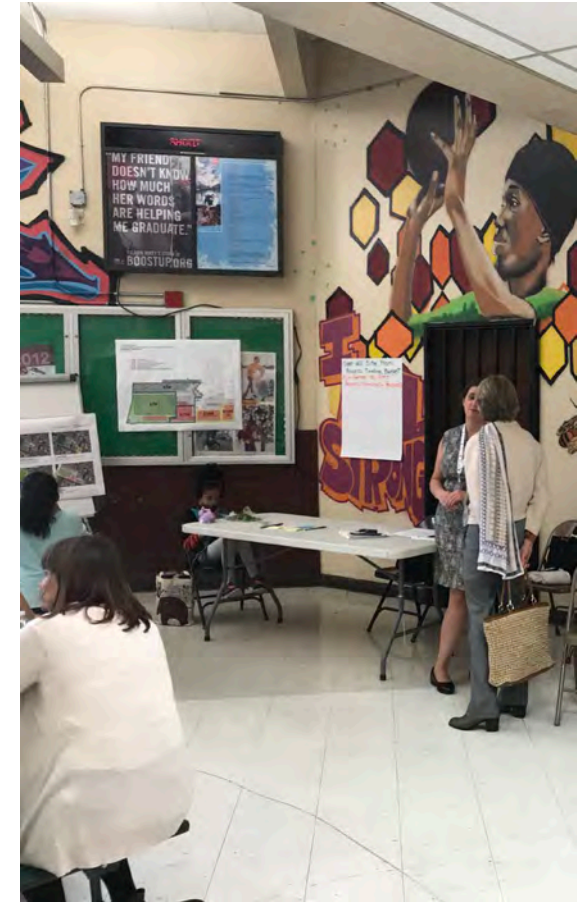

STUDENT ENGAGEMENT

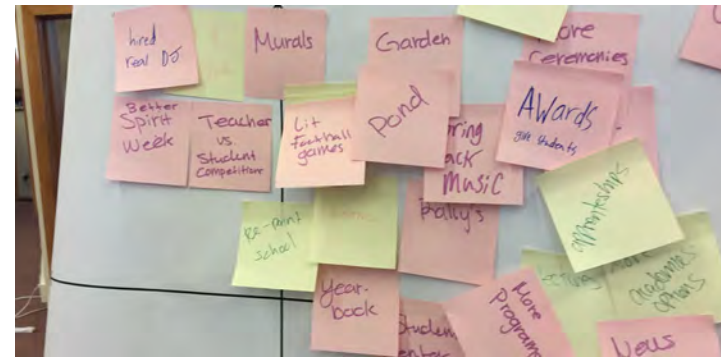



Faculty Meetings

Shared Vision and Purpose

- Need to get something done
- Support Students and Families
- Connect to the Community
- Support academic programs
- Create a sense of pride and *ownership* in Fremont HS

Organized advocacy

- **Consistent Committee representing the Community**
 - Engage with people who are the most vocal
 - Find people who are genuinely engaged and care
 - Need to have availability to participate
 - Use it to draw people into the school community
- **Diverse team with connections to different constituent groups**
- **Know when to rally support around specific issues**
- **Make sure that rationale and communication about decision making is clear**
- **Over communicate – in absence of information people make things up**

Leadership



Nydia Baez



Tom Skjervheim



Tim White



Kenya Chatman



Conversation 1 of 3

- Share an example of leadership in action relative to Community Engagement.

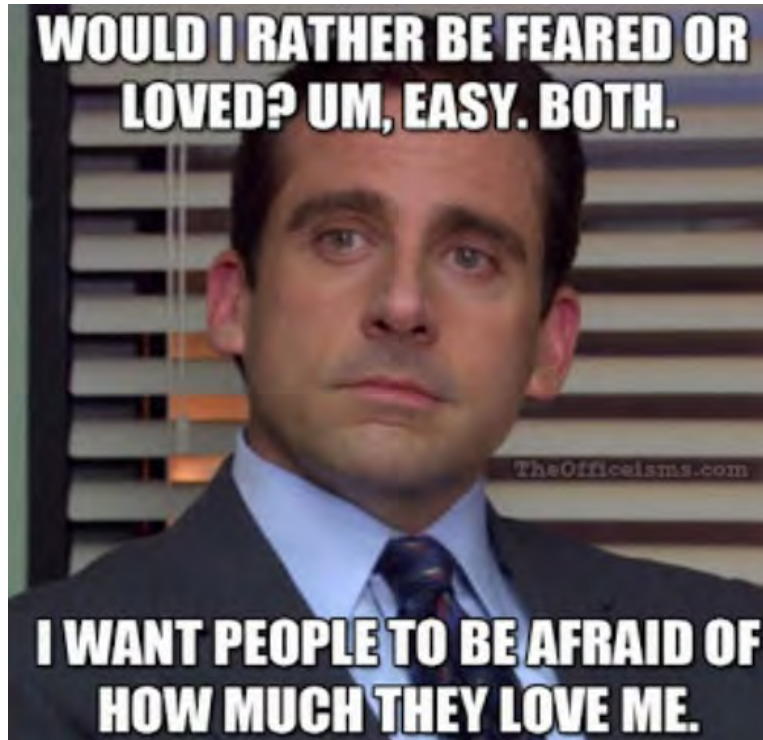

02:00

Start Stop Reset mins: 2 secs: 0 type:
None ▾

 Breaktime for PowerPoint by Flow Simulation Ltd. Pin controls when stopped



2. Design and Decisions must be Driven by Educational Program

Architecture and Engineering

Linked Learning Academy

- Hands on curriculum in design, engineering and construction
- Flexible lab spaces for fabrication and design
- Outdoor work area
- Existing wood shop
- Connected classrooms



Digital Media Academy

Linked Learning Academy

- Video recording studio
- Audio recording booths
- Editing and production lab
- Connected sports venues and classrooms



Academic Classrooms

- New general education classrooms
- State of the art science labs
- Flexible learning spaces for different teaching styles



Athletics and Wellness

- Fitness Center
- Community Wellness Clinic
- Locker rooms
- Gymnasium
- Full size football field and stadium



Conversation 2 of 3

- How do you foster student ownership of a space?



02:00

Start Stop Reset mins: 2 secs: 0 type:
None ▾

 Breaktime for PowerPoint by Flow Simulation Ltd. Pin controls when stopped



3. Have the 'Right' Team

Approach

- Listen
- Care about the project and the community
- Start from a place of Trust
- Work to understand the needs of the school and community
- Communicate options clearly and honestly to help make decisions



Change in Approach

Manage

- Traditional School design
- Rigid structures, schedules, layouts
- Focused on controlling student bad behavior
- “School is not for us”
- Based in fear
- Has contributed to inequity
- “cells and bells” design

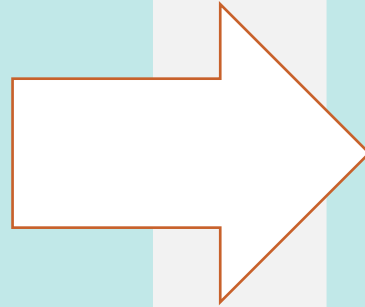

Trust

- Next Generation Schools
- Trust flows from:
 - Society to...
 - Educational Leaders to...
 - Teachers to...
 - Students
- Students feel safe and welcome
- Based on love and compassion
- Community and student ownership
- “This school is for me”
- Flexible and dynamic designs

EXPERIENCE

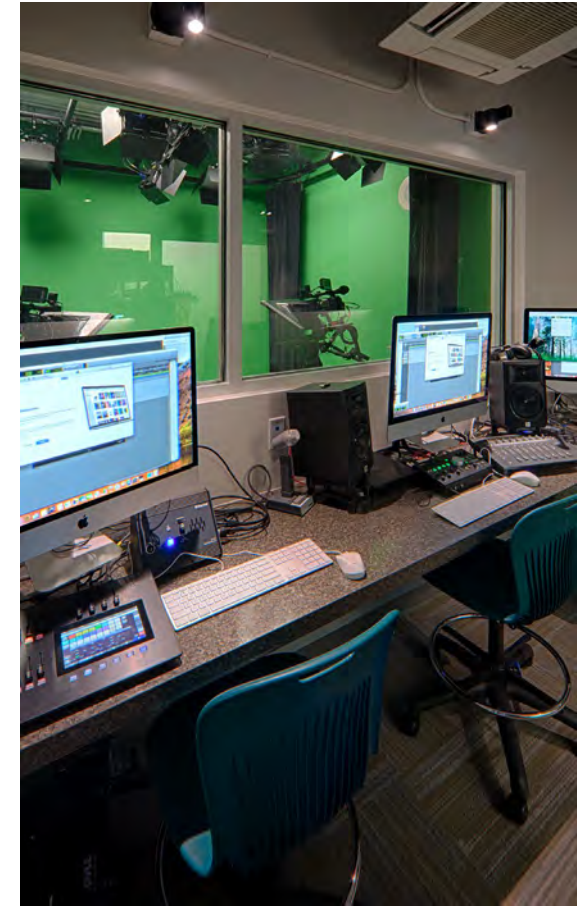

Conversation 3 of 3

- What spirit animal should a facilities team have and why?



02:00

Start Stop Reset mins: 2 secs: 0 type:
None

Breaktime for PowerPoint by Flow Simulation Ltd. Pin controls when stopped





FREMONT HIGH SCHOOL

2000



GYMNASIUM

5000





Impact on the Students

- Enrollment has increased from 400 to over 1000
- Students feel more welcome, valued and appreciated
- Free and safe to express themselves and find who they are



Impact on the Community

- 'Fremont is a feeling'
- Conversation with parents and families has gone beyond safety to the whole academic experience
- Welcoming entry helps people feel valued
- Creates more safe space for students and communities





Thank you!

